

Product End-of-Life Information

This document is intended for treatment and recycling facilities and provides information on components, materials, handling, and dismantling of the product when it reaches the end of its life, to facilitate correct and environmentally sound treatment.

Grundfos **CIU 900 M12** must be disposed of in accordance with local regulations, using authorized WEEE collectors and designated collection points. If these are not available, please contact the nearest Grundfos company or service workshop.

Safety risks

- Safety risk related to materials used:
There is no risk for people during the disassembly process posed by the materials used for the product.
- Safety risk related to handling the product:
There is no risk for people during the handling process for the product.

Disassembly of the product

The CIU900 M12 Module product consist of a Top Cover (black), the blind-mated assembly of the base PCB with the CIM Module PCB and below the PCBs is the Bottom Cover. There are two LED pipes which connect from the CIM module to the two windows on the top cover.

During dismantling and reassembly of the product, care should be observed to avoid bending or breakage of the LED pipes.

CIU 900 M12 modules can all be considered electronic scrap and should be handled as such. The only tool needed is a flat and PZ screwdriver.

Follow the following instructions to disassemble the CIU 900 M12:

- Remove the screws securing the top cover and open the CIU 900 M12.
- Loosen the earth clamp and disconnect the cables connected to the CIM module.
- Remove the screws securing the CIM module and take out the CIM module.
- Remove the middle plate.
- Remove the protection cover.
- Remove the earth plate.
- Disconnect and remove the power supply cable.
- Disconnect and remove the PE (Protective Earth) wire assembly.

Template title	GF402A0069-02 End-of-Life Information TEMPLATE	Author	GMALBG	Template version	2.0
Template ID (Link)	PROCESSDOC-1525837217-1680	Owner	GMASZEO	Template valid from	07-Apr-2025

Exploded view:

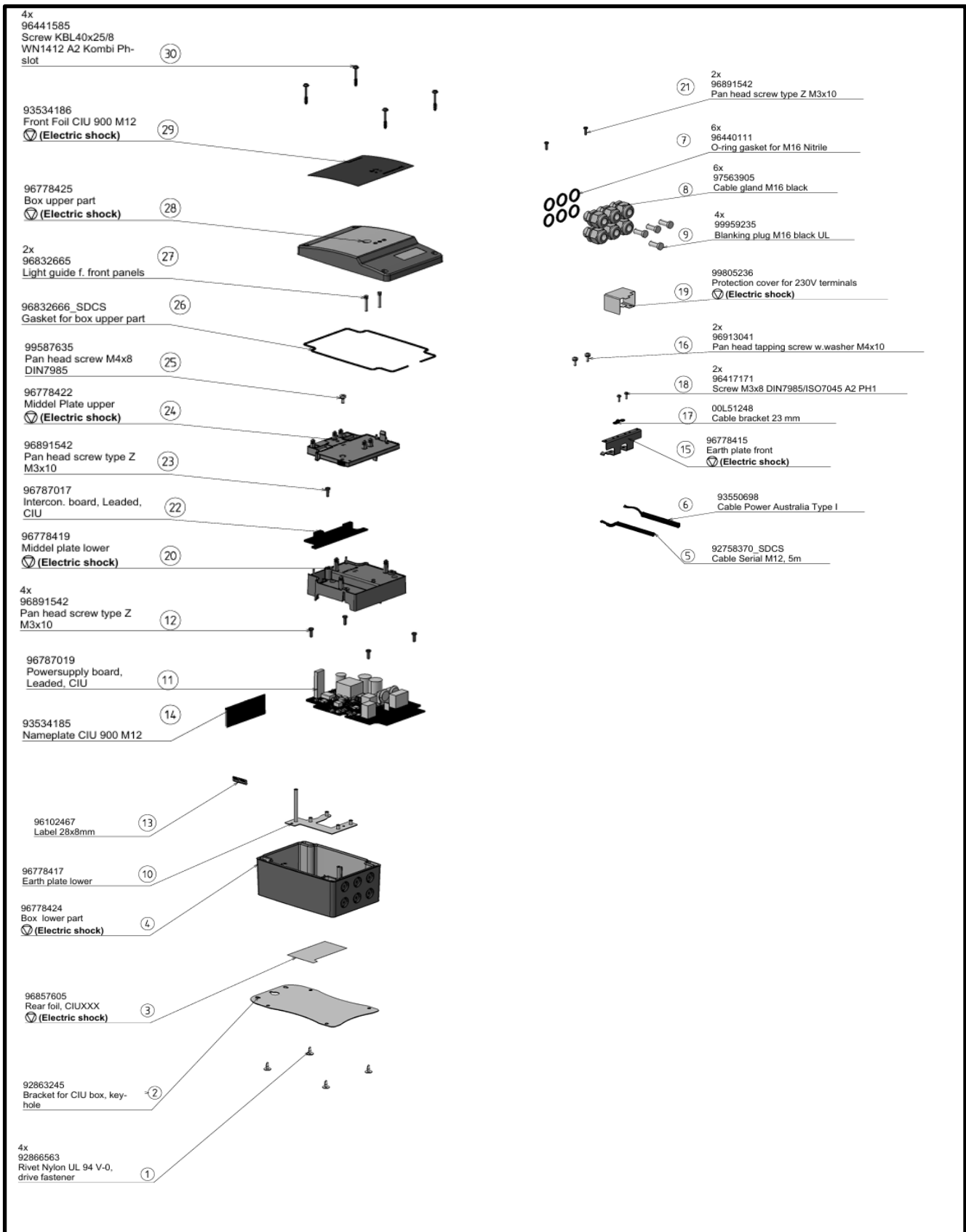

Template title	GF402A0069-02 End-of-Life Information TEMPLATE	Author	GMALBG	Template version	2.0
Template ID (Link)	PROCESSDOC-1525837217-1680	Owner	GMASZEO	Template valid from	07-Apr-2025

Designation	Component Name	Material	Special disassembly considerations
1	Rivet Nylon UL 94 V-0, drive fastener	Nylon 6/6	
2	Bracket for CIU box, key-hole	stainless steel	
3	Rear foil, CIUXXX © (Electric shock)	Boxes f/electronics	
4	Box lower part © (Electric shock)	Boxes f/electronics	
5	SDCS Cable Serial M12, 5m	Cables/Wires/Cords	
6	Cable Power Australia Type I	Cables/Wires/Cords	
7	O-ring gasket for M16 Nitrile	Nitrile Butadiene Rubber	
8	Cable gland M16 black	POLYAMIDE	
9	Blanking plug M16 black UL	Nylon 66	
10	Earth plate lower		
11	Power supply board, Leaded, CIU	ELECTRONICS (PCB)	
12	Pan head screw type Z M3x10	Stainless steel	
13	Label 28x8mm	Label 28x8 white polyester	
14	Name plate CIU 900 M12		
15	Earth plate front © (Electric shock)	Stainless steel	
16	Pan head tapping screw washer M4x10	Stainless steel	
17	Cable bracket 23 mm		
18	Screw M3x8 DIN7985/ISO7045 A2 PH1	A2 Stainless steel	
19	Protection cover for 230V terminals © (Electric shock)		
20	Middel plate lower © (Electric shock)		
21	Pan head screw type Z M3x10	Stainless steel	
22	Intercon. board, Leaded, CIU		
23	Pan head screw type Z M3x10	Stainless steel	
24	Middel Plate upper © (Electric shock)		
25	Pan head screw M4x8 DIN7985	Stainless steel	
26	SDCS Gasket for box upper part		
27	Light guide f. front panels	Optical-grade polycarbonate (PC)	
28	Box upper part © (Electric shock)		

Template title	GF402A0069-02 End-of-Life Information TEMPLATE	Author	GMALBG	Template version	2.0
Template ID (Link)	PROCESSDOC-1525837217-1680	Owner	GMASZEO	Template valid from	07-Apr-2025

29	Front Foil CIU 900 M12 © (Electric shock)
30	Screw KBL40x25/8 Stainless steel WN1412 A2 Kombi Ph slot
Additional materials:	

Template title	GF402A0069-02 End-of-Life Information TEMPLATE	Author GMALBG	Template version 2.0
Template ID (Link)	PROCESSDOC-1525837217-1680	Owner GMASZEO	Template valid from 07-Apr-2025